

P3000iE QUICK START GUIDE

WARNING This Quick Start Guide is not a substitute for reading the Operator's Manual. To reduce the risk of injury or death, user must read and understand Operator's Manual before using this product.

IMPORTANT

WARNING

Do not connect to a building's electrical system unless the generator and transfer switch have been verified by a qualified electrician. The connection must isolate the generator power from utility power and must comply with all applicable laws and electrical codes.

DANGER

Using a generator indoors CAN KILL YOU IN MINUTES. Generator exhaust contains carbon monoxide. This is a poison you cannot see or smell.



Wheel Kit Installation (Optional)

The unit comes with the rubber mounting feet installed. If you wish to install the wheel kit, please perform the following procedure.

TOOLS: 10mm Wrench, 13mm Wrench, 10mm Socket, 13mm Socket

- Carefully tip the generator onto the handle opposite the control panel to access the bottom. Remove the four existing feet with a 13mm socket.

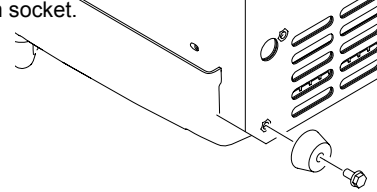

- Install the axle into the two black axle mounting brackets. Attach the axle mounting brackets with the four supplied bolts (M8 x 16) to the corresponding holes in the bottom of the generator. Use a 13mm wrench or socket.

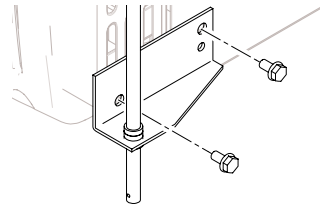

- Add a washer, a wheel, another washer and a lock pin to each end of the axle, in the specified order.

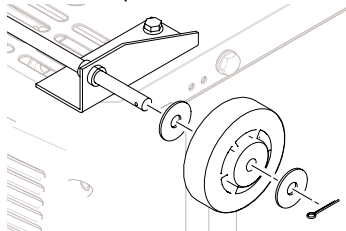

- Attach each locking swivel wheel to the bottom of the generator with the four supplied bolts (M6 x 16) using a 10mm wrench or socket. Fully tighten all mounting bolts, then return the generator to an upright position.

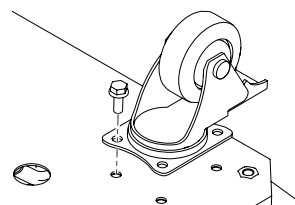

First Time Starting

- Unlock the access panel latch (1), slide the lock down until the latch handle (2) pops out. Turn the latch handle clockwise to disengage the latch.

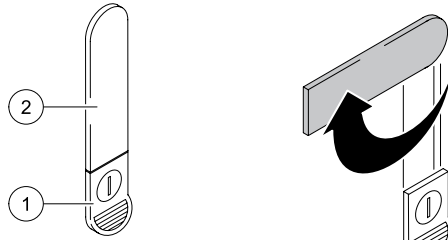

- Expose the generator inner components by swinging open the service door.

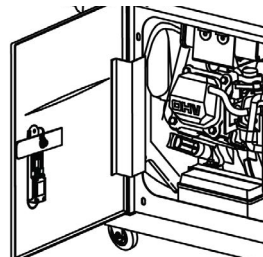

- Add engine lubricant per the Operator's Manual instructions.

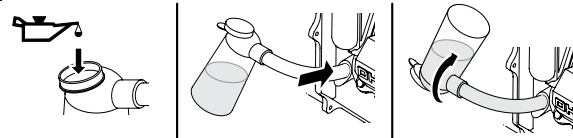

Oil fill recommendations using included oil fill bottle:

P3000iE
3 oil fill bottles up to #2 mark

Always verify oil level is at upper limit mark on dipstick before operating.

- Using supplied nuts and bolts, connect battery Cables to positive (+) and negative (-) terminals. Slide boots over cables and terminals.

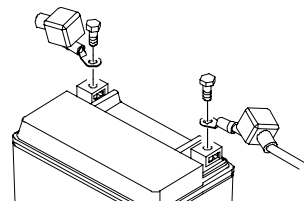

- Install and tighten battery holder over battery.

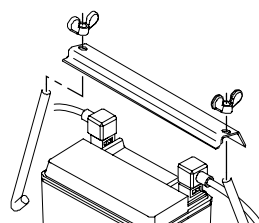

- Fill the fuel tank per the Operator's Manual instructions.

First Time Starting (Cont.)

- Position the SMART THROTTLE switch to OFF.

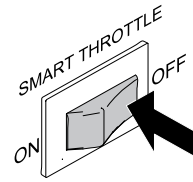

- Pull CHOKE knob out to choke engine.

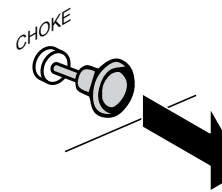

- Position the FUEL VALVE to ON.

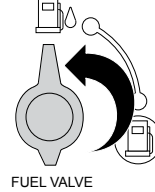

- Turn the ignition key to START position. When the engine starts, release the key.

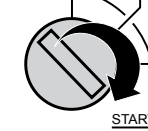

- Once the engine is running, slowly push the choke knob in to the RUN position.

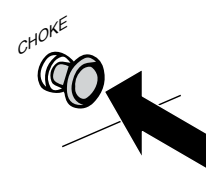

- After a 2-3 minute warm up, Position the SMART THROTTLE switch to ON.

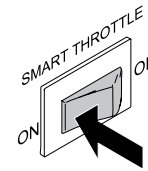

Stopping The Unit

- Disconnect all appliances connected to the generator. Position the Ignition Switch to OFF.

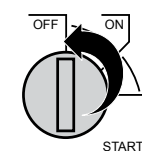

- Allow the engine to cool. Turn the FUEL VALVE to OFF.

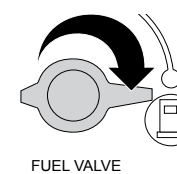

Using The Generator

Connect devices to be powered by following the steps below:

- Make sure the total rated power from the items you plan to use at the same time are less than the generator continuous (running) watts. Make sure the total surge (starting) power from the items you plan to use at the same time are less than the generator maximum watts. See Operator's Manual to calculate total amount of power needed.
- Start the generator with nothing connected.
- Plug in and turn on the first load (preferably the largest load).
- Allow the generator output to stabilize (engine runs smoothly and attached device operates properly).
- Repeat previous steps for additional loads.
- IMPORTANT: Never add more load than the generator's capacity. Please consider surge load when determining total power need.

Storing The Unit

When preparing to store the generator, allow the unit to cool completely. If the unit is going to be stored for more than 4 weeks, turn off generator by turning fuel valve to the OFF position. After the generator stops running, turn key to the OFF position. Follow complete storage instructions in Operator's Manual.

Troubleshooting

PROBLEM	POSSIBLE CAUSE	SOLUTION
Engine will not start.	<ul style="list-style-type: none"> - Engine switch is off. - No fuel. - Stale fuel or water in fuel. - Engine oil level is low. - Spark plug faulty, fouled or improperly gapped. - Choke lever is in RUN position. - Engine stored without treating or draining fuel. - Refueled with bad fuel. - Dirty fuel filter. 	<ul style="list-style-type: none"> - Turn engine switch to ON. - Fill fuel tank. - Drain entire fuel system and refill with fresh fuel. - Engine is equipped with Low Oil Shutoff. If the engine oil level is low, the unit will not start. Check engine oil level and fill if necessary. - Replace spark plug. - Move choke lever to START position. - Drain fuel and carburetor. Refuel with fresh fuel. - Contact authorized service dealer.
Engine hard to start.	<ul style="list-style-type: none"> - Water in fuel. - Weak spark at spark plug. 	<ul style="list-style-type: none"> - Drain entire system and refill with fresh fuel. - Contact authorized service dealer.
Engine lacks power.	<ul style="list-style-type: none"> - Dirty air filter. - Engine stored without treating or draining fuel, or refueled with bad fuel. 	<ul style="list-style-type: none"> - Check air filter element. - Clean or replace as needed. - Drain fuel and carburetor. - Refuel with fresh fuel.
AC receptacle does not work.	<ul style="list-style-type: none"> - Item plugged in is defective. - Overload indicator on (light solid) 	<ul style="list-style-type: none"> - Try a different item. - Press reset button.
DC receptacle does not work.	<ul style="list-style-type: none"> - Circuit protector engaged. - Item plugged in is defective. 	<ul style="list-style-type: none"> - Remove any load from the generator. - Replace the fuse, then depress the DC circuit breaker. - Try a different item.
Generator makes a "spark knock" or "pinging" noise.	<ul style="list-style-type: none"> - If knocking or pinging occurs under normal load at a steady engine speed, the problem may be with the fuel being used. - An occasional light "knocking" or "pinging" under heavy load is not a cause for concern. 	<ul style="list-style-type: none"> - Switch to a different brand of fuel with a octane rating of 86 or higher. - Contact authorized service dealer.

If problems persist after trying the above solutions, contact your authorized service dealer.

The following symptoms may indicate problems that will affect the emissions level on the unit.

- Hard starting or stalling
- Rough idle
- Misfiring or backfiring under load
- Afterburning (backfiring)
- Black exhaust smoke or high fuel consumption

If you encounter any of these symptoms, take the unit to your authorized service dealer for service.

POLARIS POWER